

Quick Network Setup Guide

Step 1. NVR/DVR/IPC Connection Diagram

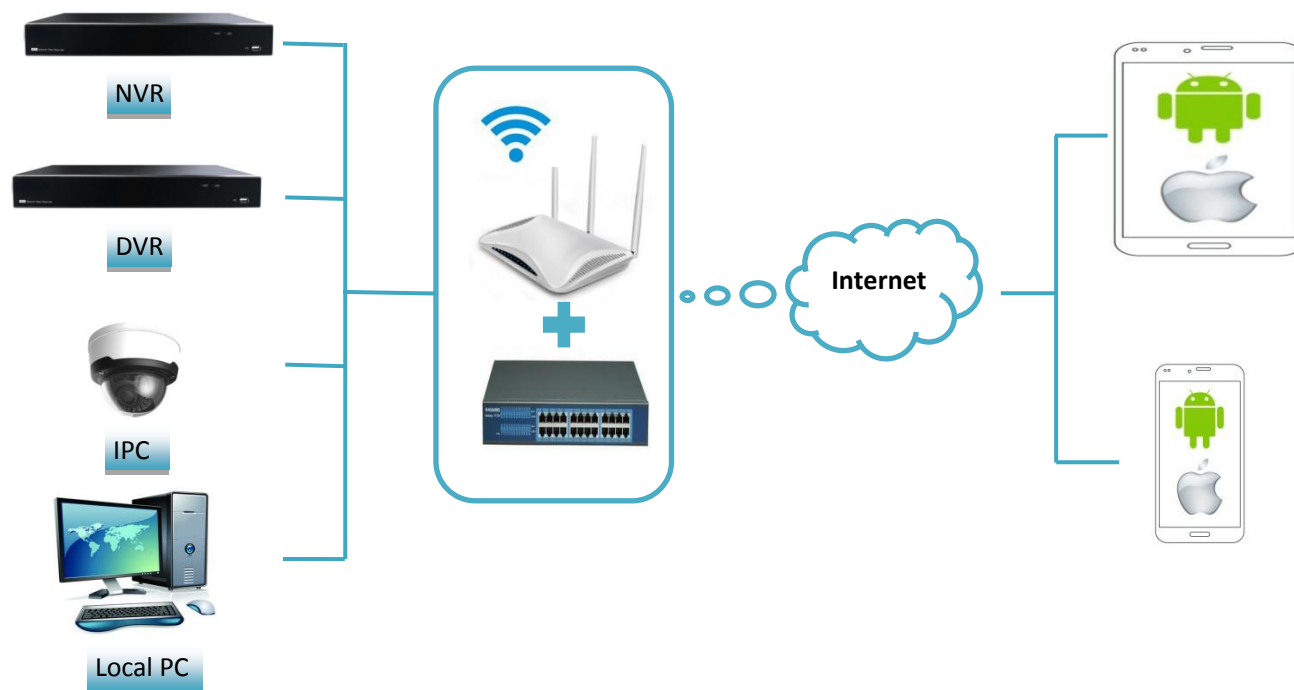

Prompt: Configured network environment, connected to the NVR/DVR/IPC then to start the use of the following steps.

Step 2. Install RXCamView App

You can open the APP Store or play Store by searching for '**RXCamView**' to download the APP on a mobile phone.

You can open the APP Store or play Store
by searching for '**RXCamview**' to download
the APP on a mobile phone.

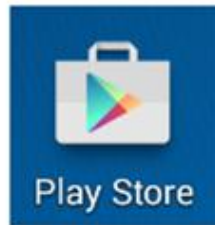
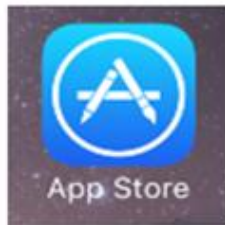

Step 3. App Menu

During start-up, you can see the menu page.

First you have to click the **Device Manager** button and enter Device page to **Add Device**.

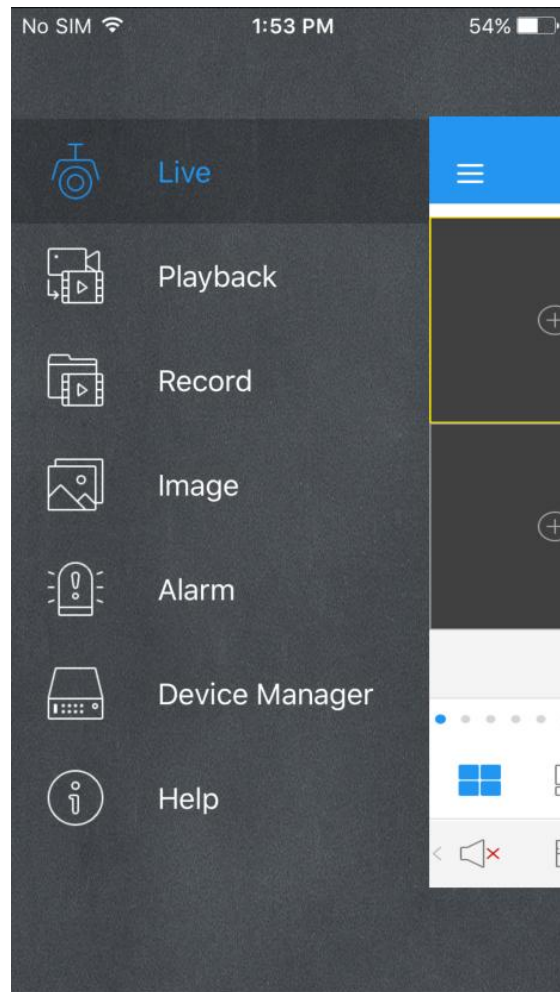

Step 4. Add Device

Open RXCamView, and go to Device page. Click ' + ' to add new device. Use the IP or Scan the QR code to connection under LAN device(NVR/DVR/IPC).Then input **client port**, **user name** and **password**, and then click **Save** to log in the device.

Save: Click to save and Start to Live View.

Device Name: Modify Device name.

Login Type: IP/DOMAIN or Device ID
IP/DOMAIN: IP address
Device ID: P2P ID

Media Port: Client Port of NVR/DVR/IPC.

User Name and Password of NVR/DVR/IPC.

Channels: Channels Number achieved from the device automatically.

Under **Device Manager** interface, slide the device to left, and then click **Delete** to remove it.

Step 5. Live view

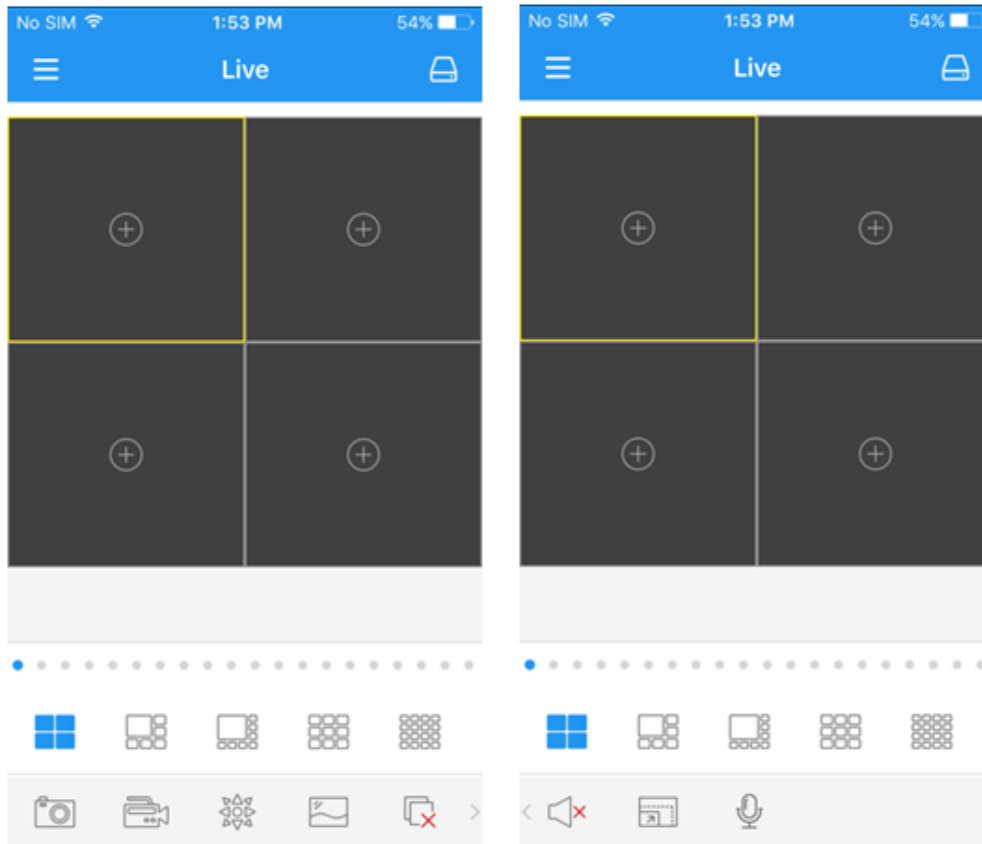

Icons	Fuction
	Go to Device List
	4/6/8/9/16 split screen
	Add Live View Channel
	Snapshot
	Record
	PTZ Control
	Image Quality Switch
	Stop Live View
	Mute on/off
	Video Size Switch
	Voice Intercom Function

Click the button you can open the Device list to add device

Click the button you can be [snapshot](#) or [record](#) of the selected channel.

Prompt: Double click to enlarge the window, and then hold or separate fingers to ZOOM in/out.

Step 6. Playback

Click  to go to Remote Playback interface.

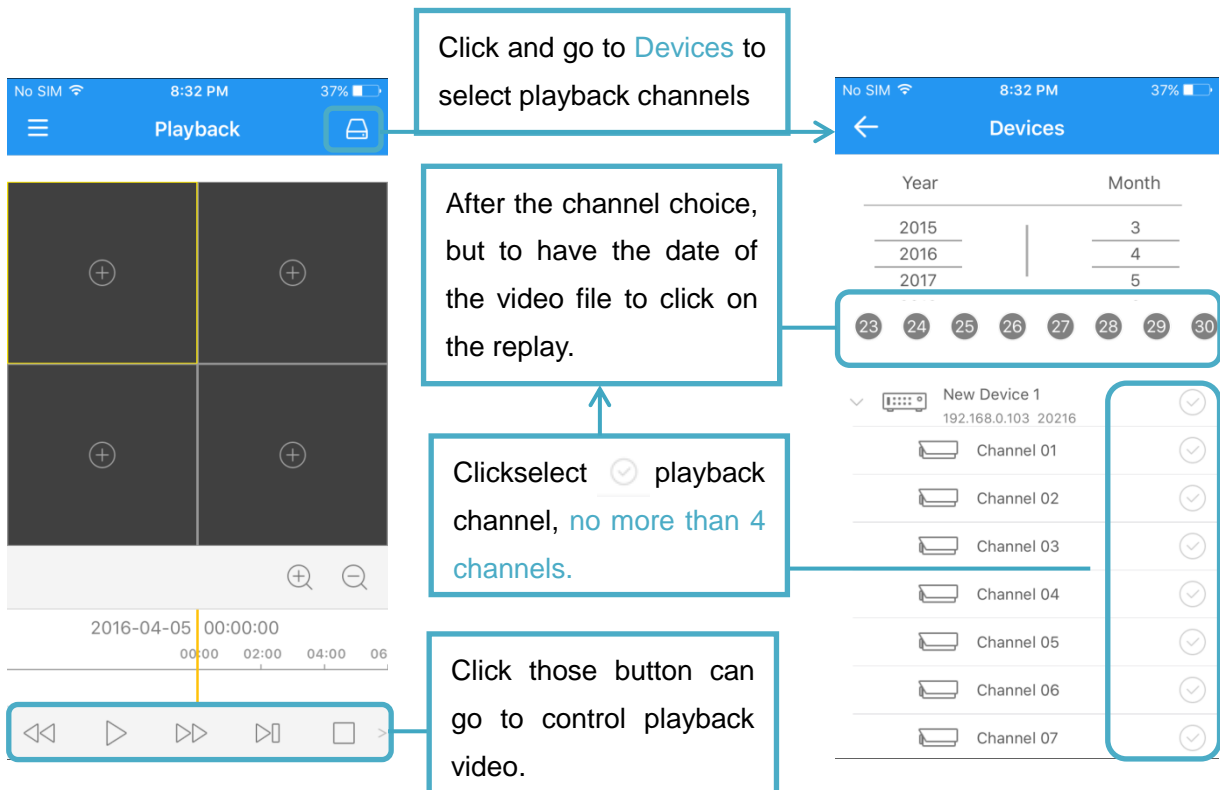

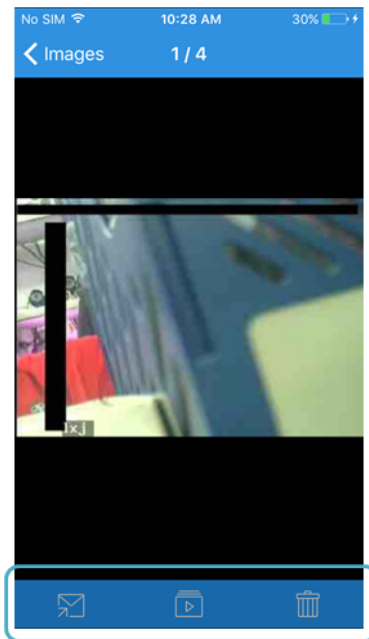

Step 7. Record& Image

In the [Live View](#) or [Playback](#), via [Record/Snapshots](#), Files will be saved in Record/Image.



Under [Image Manger](#) interface, select device to go to images interface.

Click  , by applying the software or E-mail share photos.

Click  to display images automatically.

Click  to remove images.

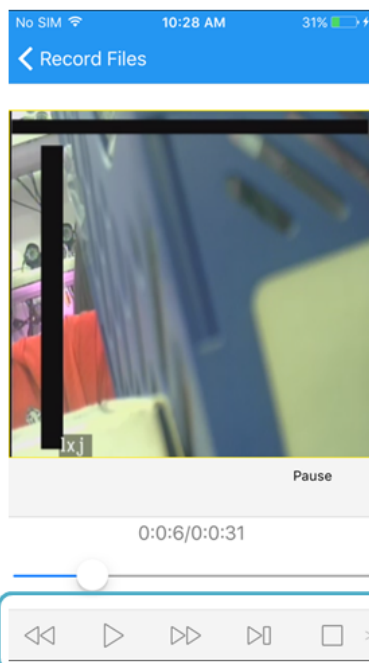

Under [Local Playback](#) interface, select device from device list to go to recording files interface and select the files you would like to replay.

Click those icons to control recording files

Step 8. Alarm

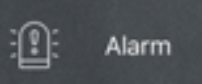
In the app menu, click  to go to Alarm interface.

